

County Fair Mall

475 Granville St N, Summerside, PEI

FOR LEASE

Marc Boudreau
Senior Manager, Leasing
mboudreau@salthillcapital.com | 514.636.4094 x 209



Highlights

County Fair Mall is the dominant Shopping Centre in western PEI, located in PEI's second largest city, Summerside. The Centre is well located along Granville Street, the town's main arterial thoroughfare and only retail node in the area. The 233,634 SF enclosed Centre offers great retail opportunities for medical services and quick service restaurants. The Centre also boasts 1,000,000 Daily Visits each year.

- Anchored by Sobeys and Giant Tiger, with McDonald's, Sport Chek, Bank of Montreal and Cineplex.

Community Spaces Program

County Fair Mall offers the community the opportunity to use space within the Centre for events, fundraisers, pop-up shops, and more, drawing ongoing foot traffic and energy to the Centre. Visit <https://www.countyfairmallpei.com/> for more information!

Demographics | 10km Radius

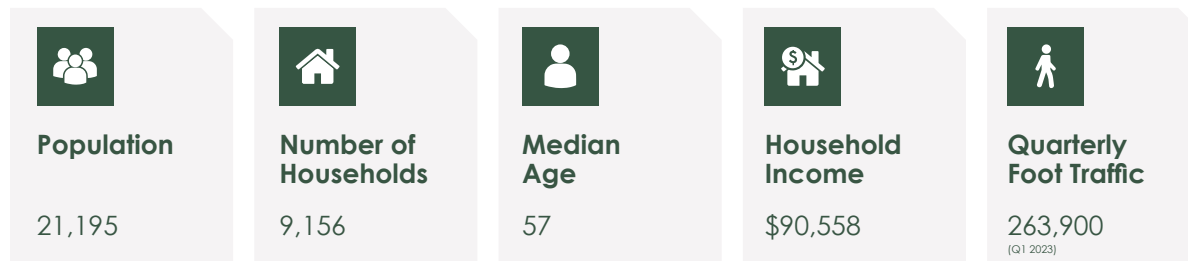

*Data from 2023 Environics Analytics.



County Fair Mall

475 Granville St N, Summerside, PEI

FOR LEASE

Marc Boudreau
Senior Manager, Leasing
mboudreau@salthillcapital.com | 514.636.4094 x 209

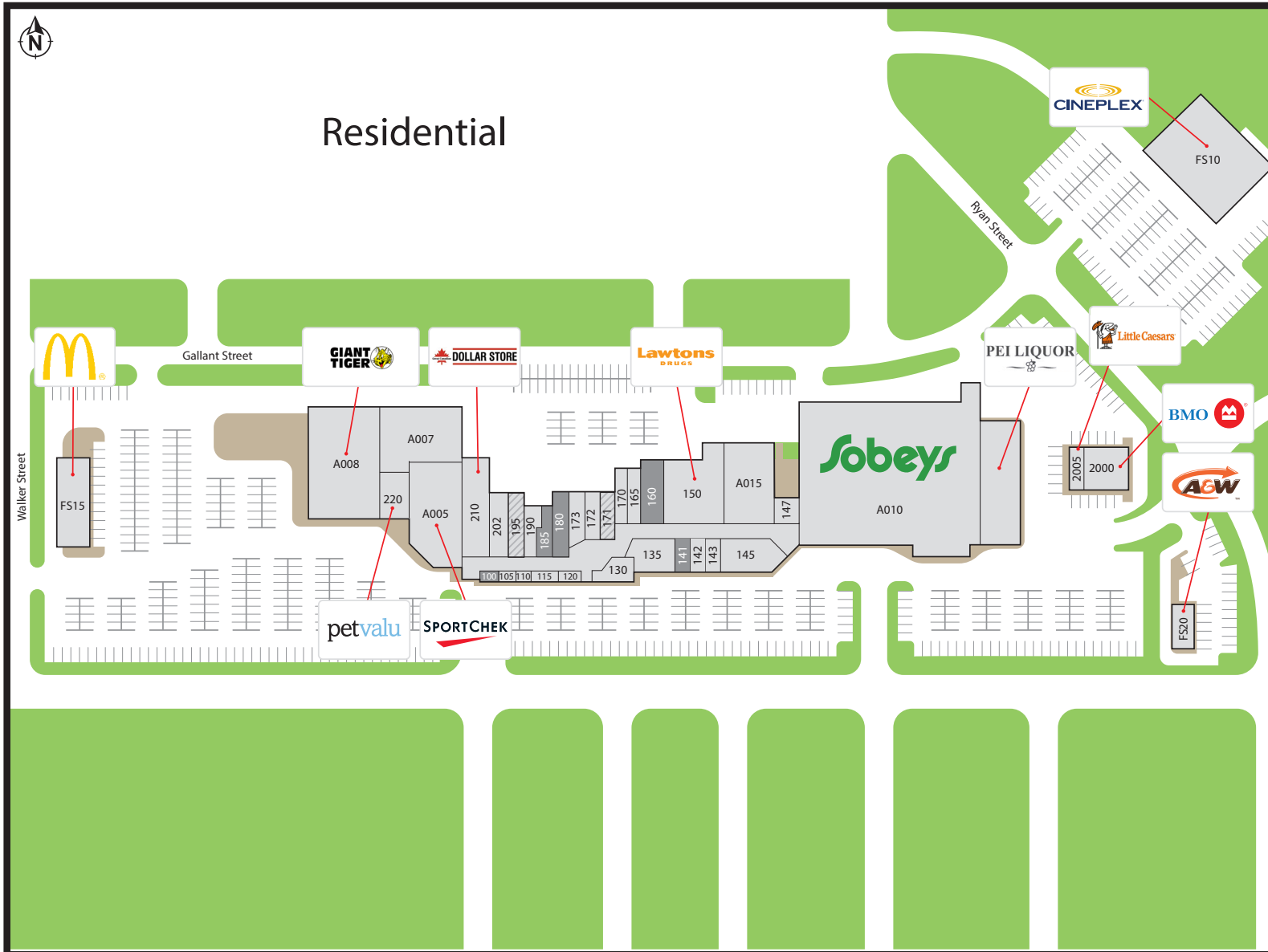

- 100. Available (547 sf)**
- 105. CJ Nails (498 sf)
- 110. Elite Convenience store (424 sf)
- 115. Taco Spot (769 sf)
- 120. Panda Sugar (499 sf)
- 130. Charm (1,683 sf)
- 135. Reitmans (3,949 sf)
- 141. Available (657 sf)**
- 142. The Salvation Army (973 sf)
- 143. Telus (999 sf)
- 145. Bluenotes (4,450 sf)
- 147. Eastlink (1,429 sf)
- 150. Lawtons Drugs (12,260 sf)
- 160. Available (3,575 sf)**
- 165. CellMix (1,260 sf)
- 170. Style Hair Salon (1,656 sf)
- 171. Great Canadian Dollar Store (1,575 sf)
- 172. Connect Hearing (1,391 sf)
- 173. Eclipse (1,981 sf)
- 180. Available (2,404 sf)**
- 185. Available (1,450 sf)**
- 190. Coles (1,835 sf)
- 195. Health PEI (2,067 sf)
- 202. Hallmark (2,234 sf)
- 210. Great Canadian Dollar Store (6,339 sf)
- 220. Pet Valu (3,378 sf)
- 2000. BMO (4,449 sf)
- 2005. Little Caesars (1,166 sf)
- A005. SportChek (13,787 sf)
- A007. Iron Haven (11,636 sf)
- A008. Giant Tiger (23,011 sf)
- A010. Sobeys (64,819 sf)
- A015. Summerside Medical (27,583 sf)
- S001. Summerside Medical (addition)
- FS10. Cineplex (18,600 sf)
- FS15. McDonald's (4,400 sf)
- FS20. A&W (1,860 sf)