

2625 Queensview Drive

Ottawa, ON

FOR LEASE

Charles Walwyn
Senior Director, Leasing | Broker
cwalwyn@salthillcapital.com | 416.646.7359



Highlights

A well maintained two storey Office Building in a suburban location with ample parking. The site offers easy access to Highway 417 and is adjacent to future a LRT station. The Building is anchored by an insurance office and health-related tenant.

- Located alongside the Queensway in the desirable west Ottawa region.



Demographics | 10km Radius



Population

513,542



Number of Households

218,108



Median Age

50



Household Income

\$128,096



People Per Household

2.35

*Data from 2023 Environics Analytics.

2625 Queensview Drive

Ottawa, ON

FOR LEASE

Charles Walwyn
Senior Director, Leasing | Broker
cwalwyn@salthillcapital.com | 416.646.7359

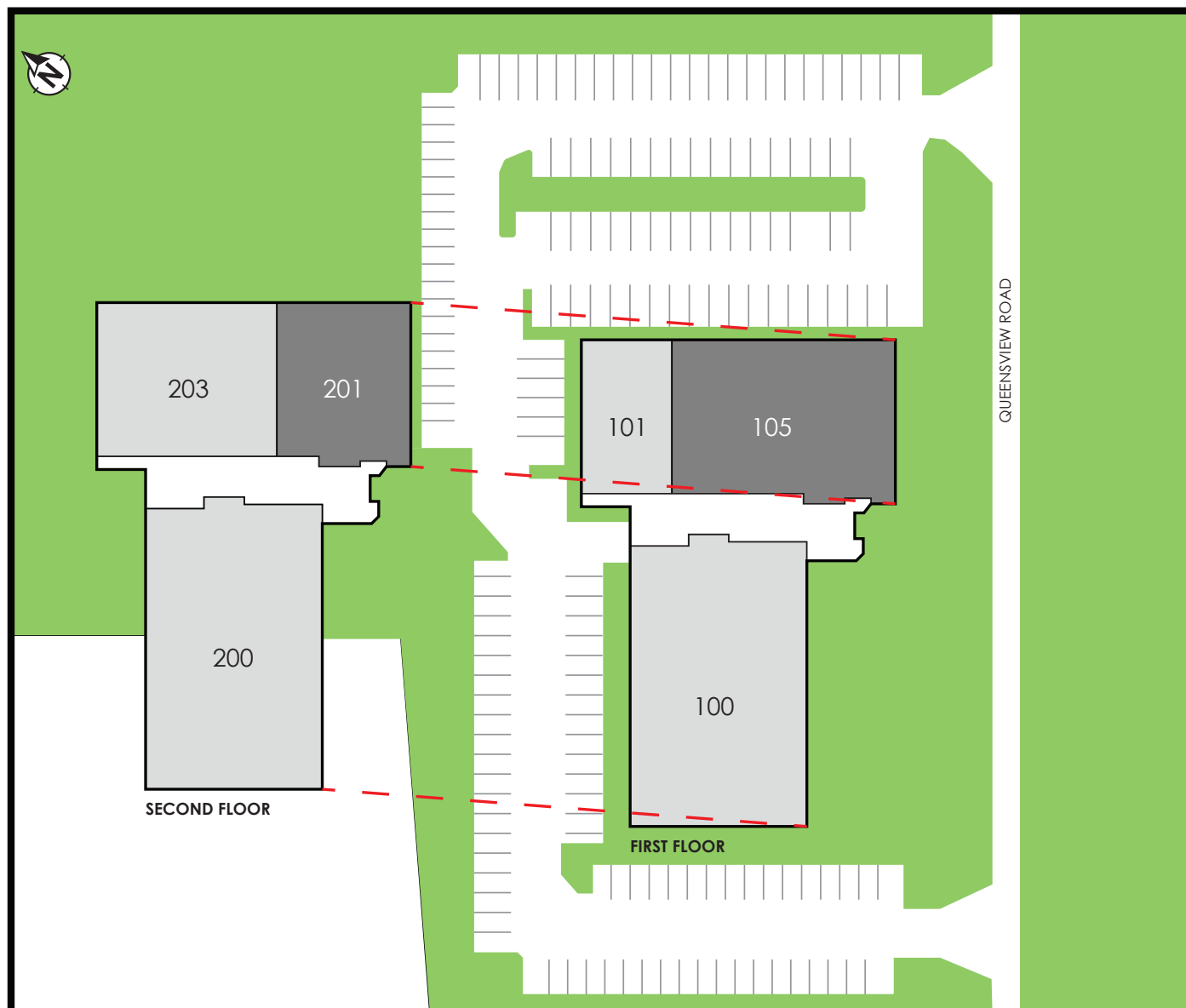

First Floor

100. Queensway Carleton Hospital (11,419 SF)

101. VHA Home Healthcare (3,085 SF)

105. Available (7,781 SF)

Second Floor

200. SCM Adjusters (12,200 SF)

201. Available (5,037 SF)

203. PIP Animation Services (6,348 SF)